

ACROPOLE

Ecrous & clés porte pinces Collet holders nuts & wrenches

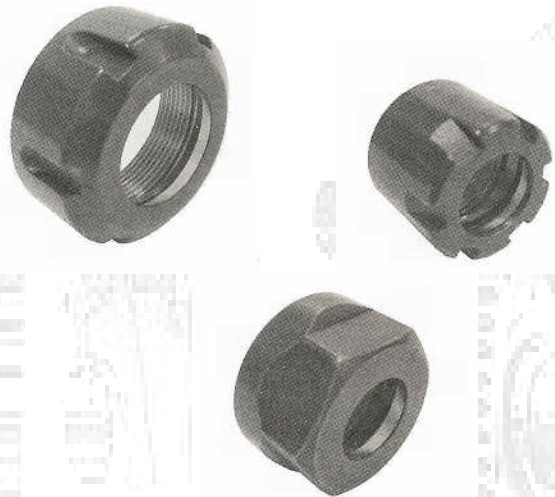

369 rue des Abeilles
PAE Les Léchères
74460 Marnaz
France

Tel : +33 (0)4 50 18 20 43
Fax : +33 (0)4 50 96 03 60

e-mail : acropole@acropole.fr
web : www.acropole.fr

Ecrou porte pinces - Collet holders nut

GHIERE MINI (MINI CLAMPING NUTS) Fig. 1				
Code	Type			Thread
ART.	Tipo	D	H	F
052.108	ERC 8	12	11	10x0.75
052.111	ERC 11	16	11	13x0.75
052.116	ERC 16	22	17	19x1
052.120	ERC 20	28	19	24x1
052.125	ERC 25	35	20	30x1

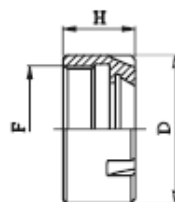

Fig. 1



GHIERE ESAGONALI (HEXAGONAL CLAMPING NUTS) Fig. 2				
Code	Type			Thread
ART.	Tipo	D	H	F
052.211	ERC 11	19	11	14x0.75
052.216	ERC 16	28	17	22x1.5
052.220	ERC 20	34	19	25x1.5

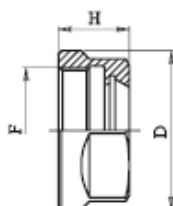

Fig. 2



GHIERE STANDARD (STANDARD CLAMPING NUTS) Fig. 3				
Code	Type			Thread
ART.	Tipo	D	H	F
052.316	ERC 16	32	17.5	22x1.5
052.320	ERC 20	35	19	25x1.5
052.325	ERC 25	42	20	32x1.5
052.332	ERC 32	50	22	40x1.5
052.340	ERC 40	63	25	50x1.5
052.350	ERC 50	78	35	64x2

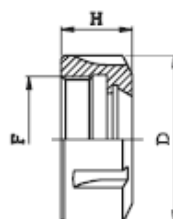

Fig. 3



GHIERE FILETTO ESTERNO (EXTERNAL THREAD NUTS) Fig. 4				
Code	Type			Thread
ART.	Tipo	D	H	F
052.411	ERC 11	...	6	18x1
052.411 B*	ERC 11	...	6	18x1
052.416	ERC 16	...	8	24x1
052.420	ERC 20	...	11	28x1.5
052.425	ERC 25	...	12.5	32x1.5
052.432	ERC 32	...	14	40x1.5
052.432 B*	ERC 32	...	14	40x1.5

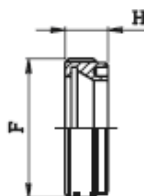
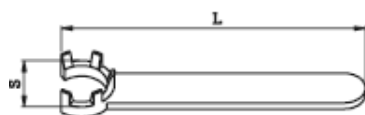

Fig. 4



* Per chiave esagonale - * For hexagonal wrenches

Clés pour écrous - Wrenches for collet holders nut



Code	S	L	For Nut Code
ART.	S	L	per ghiera art.
053.108	12	80	052.108
053.111	16	96	052.111
053.116	22	118	052.116
053.120	28	130	052.120
053.125	35	132	052.125

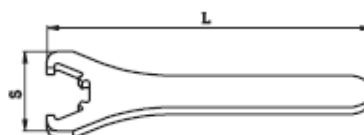

Code	S	L	For Nut Code
ART.	S	L	per ghiera art.
053.316	50	160	052.316
053.320	57	180	052.320
053.325	65	210	052.325
053.332	75	250	052.332
053.340	90	290	052.340
053.350	110	350	052.350

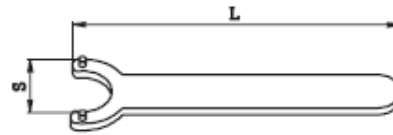

Code	S	L	For Nut Code
ART.	S	L	per ghiera art.
053.420	20.5	160	052.420
053.425	23.5	180	052.425
053.432	32	200	052.432

DEMANDEZ NOS CATALOGUES
ASKED FOR OUR CATALOGUES

Equipements – Pièces détachées – Pincettes – accessoires
Equipment – Spare parts – Collets - Accessories



GILDEMEISTER
AS16 – GM16 - AS20 – GS20 – GM20



GILDEMEISTER
GM32 – GM35 – GM42

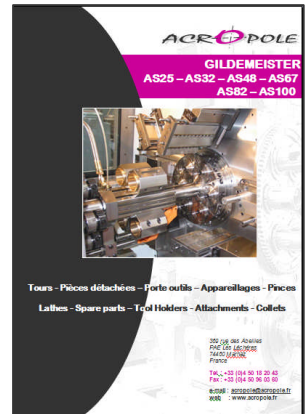

GILDEMEISTER
AS25 – AS32 – AS48 – AS67 – AS82 – AS100

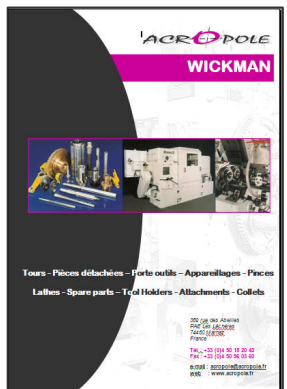

WICKMAN



TORNOS
AS14 – SAS16 – BS20

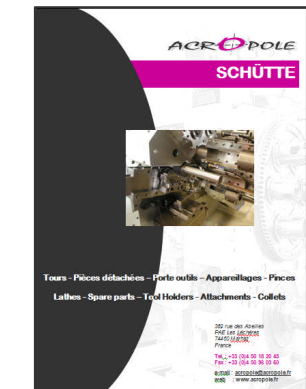

SCHÜTTE



Porte outils – Appareillages
Tours Multibroches
Tool holders - Attachments



Pincettes
Collets



Clés & vis Anglaises
Wrenches & English screws



ACROPOLE

369 rue des Abeilles
PAE Les Léchères
74460 MARNAZ
France

Tel : +33 (0)4 50 18 20 43
Fax : +33 (0)4 50 96 03 60

acropole@acropole.fr
www.acropole.fr